

This is a 'PROVISIONAL BUILDING PLAN' approved only for the purpose of inviting applications from the general public.

*Arrop Associates Pvt. Ltd.*

- NOTES:—
- BUILDING HAS AUTOMATIC SPRINKLER SYSTEM AS REQUIRED BY NBC.
  - BUILDING WILL BE DESIGNED (STRUCTURES) AS PER RESISTANCE IS CODES FOR EARTH QUAKE RESISTANCE.
  - BUILDING IS ARTIFICIALLY LIGHTED MECHANICALLY VENTILATED & CENTRALLY AIRCONDITIONED WITH 100% POWER BACKUP.

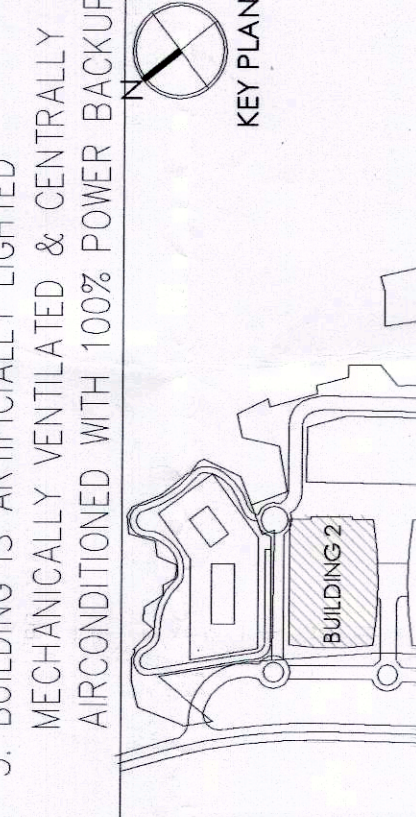
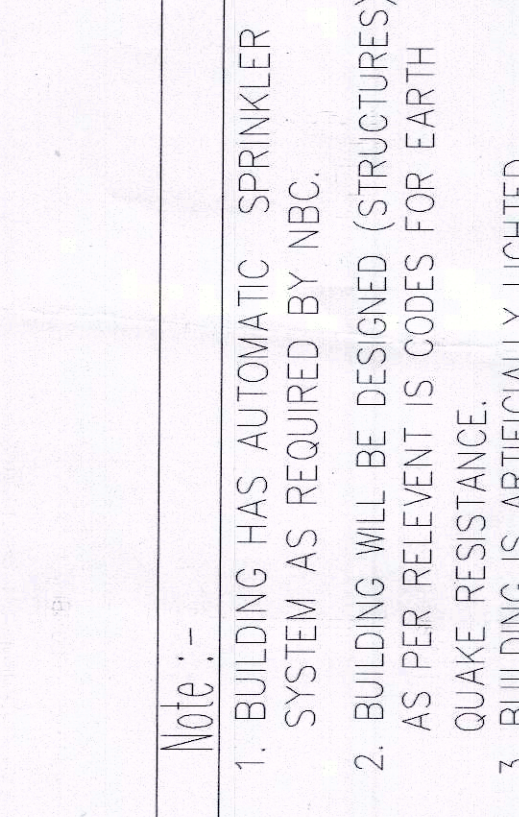

LEGEND OF PLUMBING:

S.N.O.	SYMBOL	DESCRIPTION
01.	①	110 OD SOL PIPE
02.	②	110 OD WASTE PIPE
03.	③	75 OD ANTISEIPHONAGE PIPE
04.	④	DOMESTIC WATER SUPPLY HYDROAUMATIC
05.	⑤	DOMESTIC WATER SUPPLY HYDROAUMATIC
06.	⑥	FUSHING WATER SUPPLY HYDROAUMATIC
07.	⑦	160 OD TERRACE RAIN WATER PIPE
08.	⑧	110 OD MUMTY/BALCONY RAIN WATER PIPE
09.	⑨	FLOOR DRAIN
10.	⑩	FLOOR TRAP
11.	⑪	URINAL TRAP
12.	⑫	CLEAN OUT PLUG
13.	⑬	SOL PIPE
14.	⑭	WASTE PIPE
15.	⑮	RAIN WATER PIPE
16.	⑯	DOMESTIC WATER PIPE
17.	⑰	DOMESTIC WATER PIPE
18.	⑱	FLUSHING WATER PIPE

**Architects:**  
**Arrop Associates Pvt. Ltd.**  
Plot-36b, Sec-32, Gurgaon-122001  
Ph.: +91-124-4595500 FAX: +91-124-4595550  
Montreal, Toronto, New-Delhi, Boston

Project: PROPOSED REVISED BUILDING PLAN OF COMMERCIAL COLONY AREA MEASURING 32.38 ACRES PART OF RESIDENTIAL PLOTTED COLONY NAMEDLY DLF CITY PHASE II (III) AND INDEPENDENT COMMERCIAL COLONY 4.00 ACRES LICENCE NO.59 OF 2018  
DATED 07.09.2018) BY MAKING TOTAL AREA MEASURING 36.36 ACRES UNDER TOD ZONE IN SECTOR -24 & 25A GURGRAM MANESAR URBAN COMPLEX BEING DEVELOPED BY DLF LIMITED AND OTHERS.

DRAWING TITLE:—  
SIXTH FLOOR(REFUGE FLOOR), F.A.R. BUILDING-4

JOB NO:— DTN/B4/110  
SCALE:— 1:200  
DATE:— 25-05-2021  
CHECKED BY:— APPROVED BY:  
MAHJI VIKRAM BYVKRAM  
ARCHITECT'S SEAL & SIGNATURE  
OWNER'S SEAL & SIGNATURE

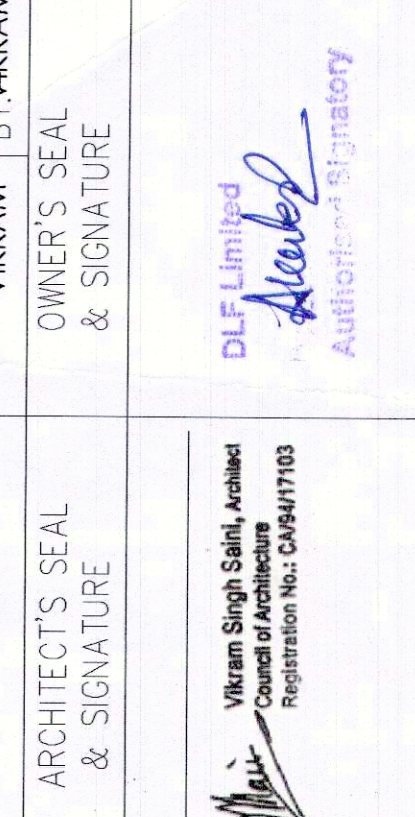

OSDP WINDOW SCHEDULE

NO.	NO.	NO.	NO.	NO.	NO.	NO.	NO.	NO.	NO.	NO.	NO.	NO.	NO.	NO.	NO.	NO.	NO.	NO.	NO.	NO.
1	100	100	100	100	100	100	100	100	100	100	100	100	100	100	100	100	100	100	100	100

ADDITION AREA FAR (SIXTH FLOOR, BUILDING 4)

TNO.	TYPE	NO.	Length	Breadth	Area(Q)	Total Area
A	SEGMENT	4	2.89	0.37	0.776431	2.865724
B	SEGMENT	3	2.89	0.37	0.776431	2.865724
C	SEGMENT	2	2.89	0.37	0.776431	2.865724
D	RECTANGLE	2	39.51	1.73	68.0443	138.0686
E	SEGMENT	2	144.25	14.76	1476.517	2833.0342
F	RECTANGLE	1	45.84	144.38	6321.482	6323.4616
TOTAL ADDITION AREA IN SQM						5423.5464

SUBTRACTION AREA FAR (SIXTH FLOOR, BUILDING 4)

TNO.	TYPE	NO.	Length	Breadth	Area(Q)	Total Area
24	RECTANGLE	4	1.03	1.53	1.5859	6.3386
25	RECTANGLE	8	0.4	0.6	0.24	1.92
26	RECTANGLE	8	0.4	0.6	0.24	1.92
27	RECTANGLE	3	0.5	2.55	1.275	3.825
28	RECTANGLE	2	1.1	2	2.2	4.4
29	RECTANGLE	1	0.8	0.8	0.64	0.64
30	RECTANGLE	2	3.1	4.25	13.175	26.35
31	RECTANGLE	2	1.45	1.35	1.9575	3.915
32	RECTANGLE	2	1.45	2.7	3.915	7.83
33	RECTANGLE	4	1.1	2.55	3.245	12.98
34	RECTANGLE	1	1.1	2.55	3.245	3.245
35	RECTANGLE	12	0.35	1.3	1.14	13.68
36	RECTANGLE	2	0.95	1.35	1.2825	2.565
37	RECTANGLE	4	0.95	2.5	2.375	9.5
38	RECTANGLE	8	0.6	1.2	0.72	5.76
39	RECTANGLE	1	0.85	0.85	0.7225	2.89
40	RECTANGLE	1	0.85	0.85	0.7225	2.89
41	RECTANGLE	1	0.85	0.85	0.7225	2.89
42	RECTANGLE	3	0.95	1	0.95	2.85
43	RECTANGLE	4	2.4	2.85	6.84	27.85
44	RECTANGLE	4	0.95	3.65	3.4775	13.11
45	RECTANGLE	4	0.95	3.65	3.4775	13.11
46	RECTANGLE	1	0.45	0.4	0.18	0.45
47	RECTANGLE	1	0.95	2.9	2.755	2.755
48	RECTANGLE	1	0.95	3.35	3.1825	3.1825
49	RECTANGLE	8	2.3	1.5	3.45	28.44
50	RECTANGLE	1	5.15	4.85	24.9775	24.9775
51	RECTANGLE	1	0.9	3.35	3.015	3.015
52	RECTANGLE	4	2.4	0.7	1.68	6.72
53	RECTANGLE	3	0.9	3.3	2.97	11.32
54	RECTANGLE	2	1.05	1.35	1.4175	2.835
55	RECTANGLE	2	1.05	1.35	1.4175	2.835
56	RECTANGLE	2	1.45	1.45	2.1025	4.205
57	RECTANGLE	2	1.45	2.7	3.915	7.83
58	RECTANGLE	3	0.95	3.7	3.5175	10.545
59	RECTANGLE	3	0.95	3.7	3.5175	10.545
60	RECTANGLE	4	0.3	1.25	0.375	1.5
61	RECTANGLE	4	1.2	1.35	1.62	6.48
62	RECTANGLE	2	1.2	2.95	3.54	7.08
63	RECTANGLE	2	0.95	2.1	1.995	3.99
64	RECTANGLE	4	4.3	0.9	3.87	17.48
65	RECTANGLE	4	4.3	0.9	3.87	17.48
66	RECTANGLE	7	5.15	5.1	26.265	198.855
67	RECTANGLE	4	3.65	1.6	5.84	23.32
68	RECTANGLE	4	3.65	1.6	5.84	23.32
69	RECTANGLE	4	0.35	2.53	0.8875	6.48
70	RECTANGLE	4	0.35	2.53	0.8875	6.48
71	TRIANGLE	4	0.3	1.6	0.24	0.96
72	RECTANGLE	1	0.95	3.35	3.1825	3.1825
73	RECTANGLE	2	0.7	0.8	0.56	1.12
74	RECTANGLE	4	0.35	2.53	0.8875	6.48
75	RECTANGLE	2	1.15	1.58	1.817	4.48
76	RECTANGLE	2	1.15	1.58	1.817	4.48
77	RECTANGLE	2	1.7	0.6	1.02	2.04
78	RECTANGLE	1	1.85	0.6	1.11	1.11
79	RECTANGLE	2	10	14.43	144.3	288.6
80	RECTANGLE	1	8.9	15.5	138.05	138.05
81	RECTANGLE	1	16.15	20.8	335.92	335.92
82	RECTANGLE	1	8.72	20.8	181.376	181.376
83	RECTANGLE	1	8.9	15.5	138.05	138.05
84	RECTANGLE	1	24.89	20.8	517.712	517.712
TOTAL SUBTRACTION AREA IN SQM						2044.098
EXCESSIVE REFUGE IN FAR						472.247
TOTAL AREA IN SQM						7869.599

REFUGE AREA CALCULATION:

CROSS SECTION	WIDTH	HEIGHT	SQM
REFUGE FLOOR	18.00	2.00	36.00
REFUGE AREA REQUIRED	18.00	2.00	36.00
TOTAL REFUGE AREA	18.00	2.00	36.00
EXCESSIVE REFUGE AREA	18.00	2.00	36.00

PIPE DIAS

S.N.O.	SYMBOL	DESCRIPTION
1	WB, TO FT	40 OD
2	URNAL, TO UT	50 OD
3	FD, TO FT	63 OD
4	FT/UT TO VERTICAL STACK	110 OD
5	WC, TO VERTICAL STACK	110 OD

NOTES:—

- ALL PIPE DIAMETERS ARE IN MM.
- ALL CONNECTIONS FLOOR DRAIN TO FLOOR TRAP WILL BE 60 UPVC WASTE PIPE.
- ALL WASTE FROM WASH BASIN, TO UT WILL BE 40 UPVC WASTE PIPE.
- ALL WASTE FROM URINALS, TO UT WILL BE 50 OD UPVC SOIL PIPE.
- ALL PIPES FROM FT TO STACK WILL BE 110 OD UPVC PIPES OR OTHERWISE SPECIFIED.
- ALL PIPES FROM WC/UT TO STACK WILL BE 110 OD UPVC PIPES OR OTHERWISE SPECIFIED.

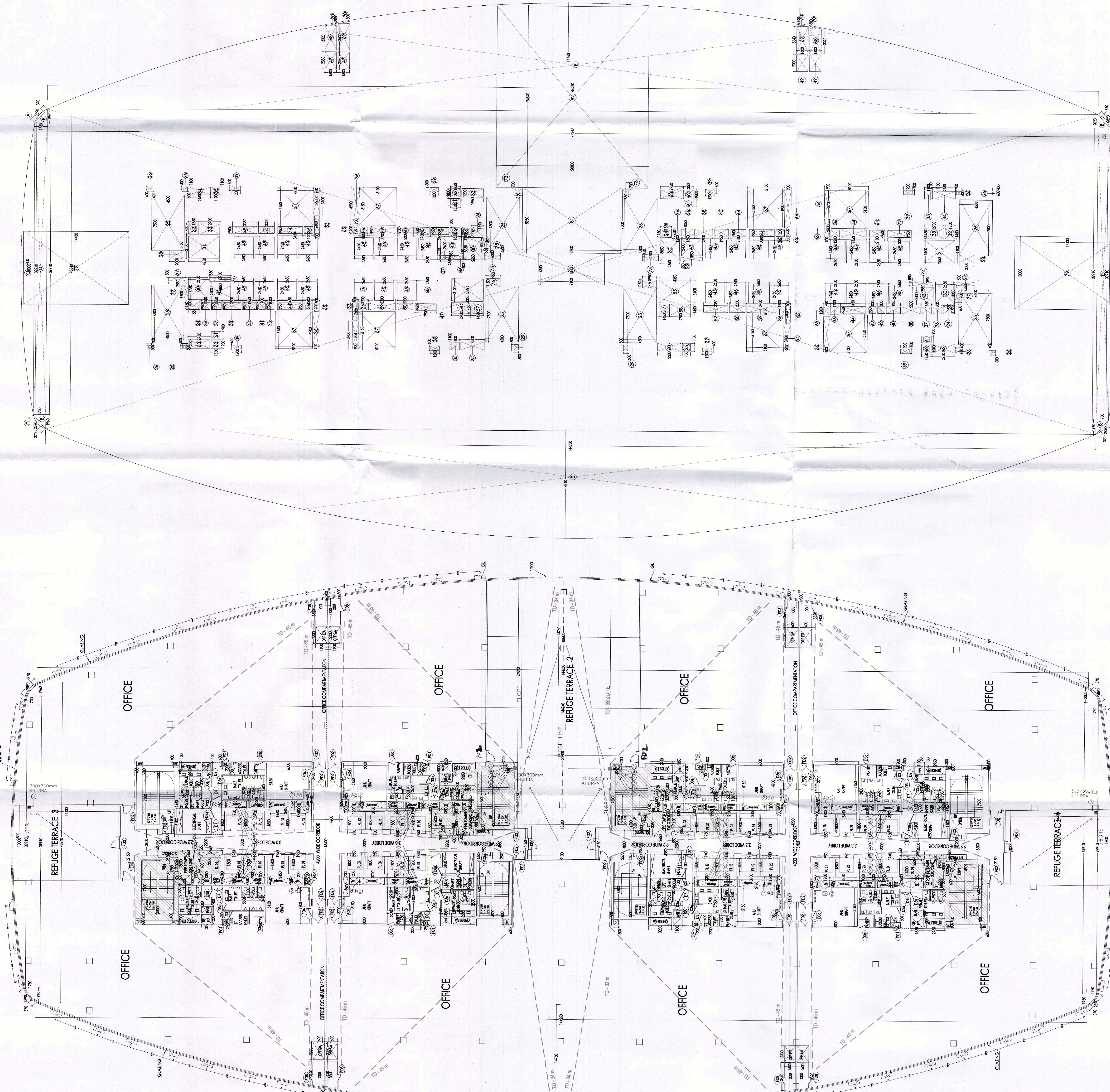

SIXTH FLOOR PLAN  
1:200  
Note: Operable windows are provided @ c/c distance less than 10 meters.  
LEVEL (+25690) - Compartments shall be 2m. physical partition / fire retard curtain.

AREA DIAGRAM OF SIXTH FLOOR PLAN